

## Introduction

### ► Feature

Line pull:	2,722 kg / 6,000 lb first layer
Wire rope:	7.1 mm × 24.4 m galvanized aircraft A7 × 19
Brake:	Full Load Holding Proprietary Cone Brake
Clutch:	Lift and turn T Bar to activate free spool
Control:	Handheld pendant switch

### ► Unpacking

- Winch assembly..... 1 pc
- Control box ..... 1 pc
- Remote control..... 1 pc
- Wire rope with hook..... 1 pc
- Roller fairlead..... 1 pc
- 1.8 m ( 6' ) 6 gauge battery leads..... 1 pc

### ► Read this manual carefully

Carefully read and understand this manual before operating the winch.

Careless winch operation may result in personal injury, danger to others and or damage to property

## Installation

### ► Winch and roller fairlead mounting

- It is important that the winch is mounted on a flat and hard surface or mounting channel to ensure the motor, drum and gearbox housing align correctly.
- Roller fairlead does not mount to winch directly.
- The wire rope shall be wound in an under-wound orientation only.
- Four (4) M10 x 1.50 pitch 10.9 grade high tensile steel bolts must be used in order to sustain the loads imposed on the winch mounting.

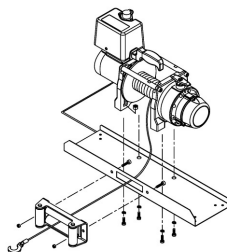

## ► Wiring Diagram

Attach the black lead firmly to the negative (–) battery terminal and red lead to the positive (+) battery terminal. The voltage drop for the winch motor must not exceed 10% of the nominal voltage of 12vdc

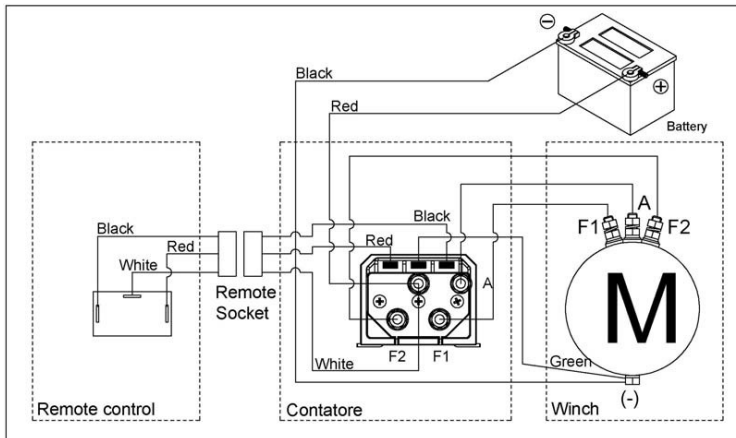

## ► Correct method to tighten the motor & contactor nuts

1. Hold the lower nut on the stud and tighten the upper nut clockwise.
2. The torque setting for the nut is 124 lb-in.

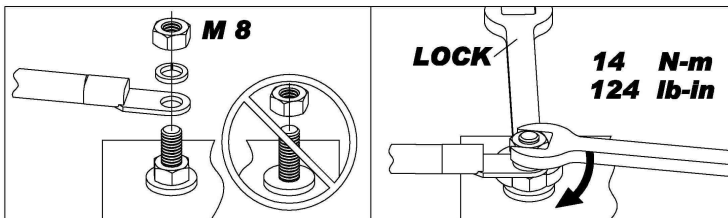

## Warning

- The winch is not to be used for transporting or lifting of personnel.
- The rated line pull shown is based on the first layer of rope on the drum.
- The rope shall remain with at least 5 wraps on the drum at all times
- The manufacturer is not responsible for damage to the wire rope

## **Parts List**

Item No.	Description	Part No.	Qty
1	Motor 12V	881505	1
2	Tie bar kit	882256	2
3	Motor support rack	880077	1
4	Motor coupling	880078	1
5	Drum bushing	880006	1
6	Drum kit	880080	1
7	Drum bushing B	880081	1
8	Gearbox support rack	880082	1
9	Wire rope w/hook	882329	1
10	1 <sup>st</sup> shaft	880084	1
11	Grounding lead	880040	1
12	3 <sup>rd</sup> ring gear kit	880086	1
13	2 <sup>nd</sup> stage carrier	880087	1
14	1 <sup>st</sup> stage carrier	880088	1
15	Retaining ring	880089	1
16	1 <sup>st</sup> & 2 <sup>nd</sup> ring gear	880090	1
17	1 <sup>st</sup> pinion kit	880091	1
18	Clutch kit	880092	1
19	Gear box kit	880093	1
20	Cone brake disc kit	880094	1
21	Brake clutch base	881099	1
22	Brake cover kit	880095	1
23	Roller fairlead WA-0508	880096	1
24	Mounting hardware	880097	1
25	Remote control WA-0310	880025	1
26	Handsaver strap	880026	1
27	Control box 12V	882265	1
27-1	Remote socket kit	880029	1
27-2	Control pack 12V	882266	1

# Winch Assembly

